

4 Planta Baixa - Det. Largura
1 : 50

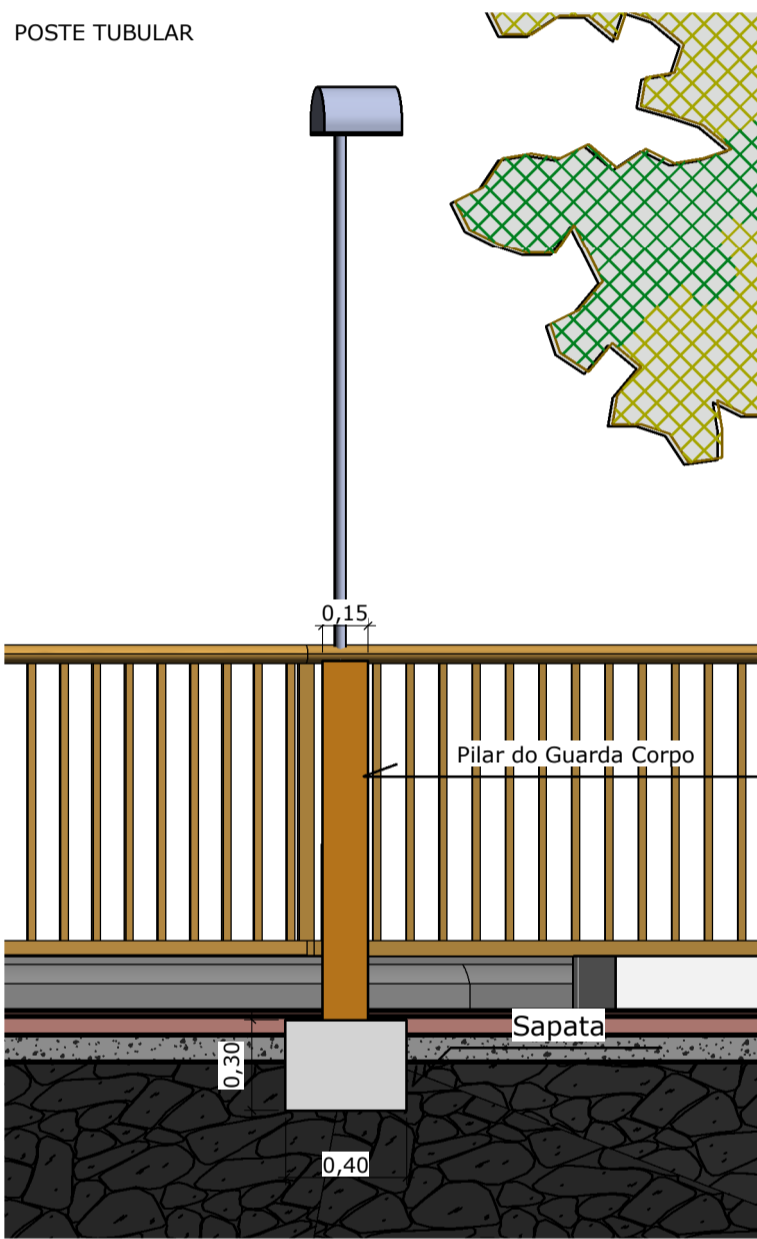

5 Det. Pilar Guarda corpo
1 : 25

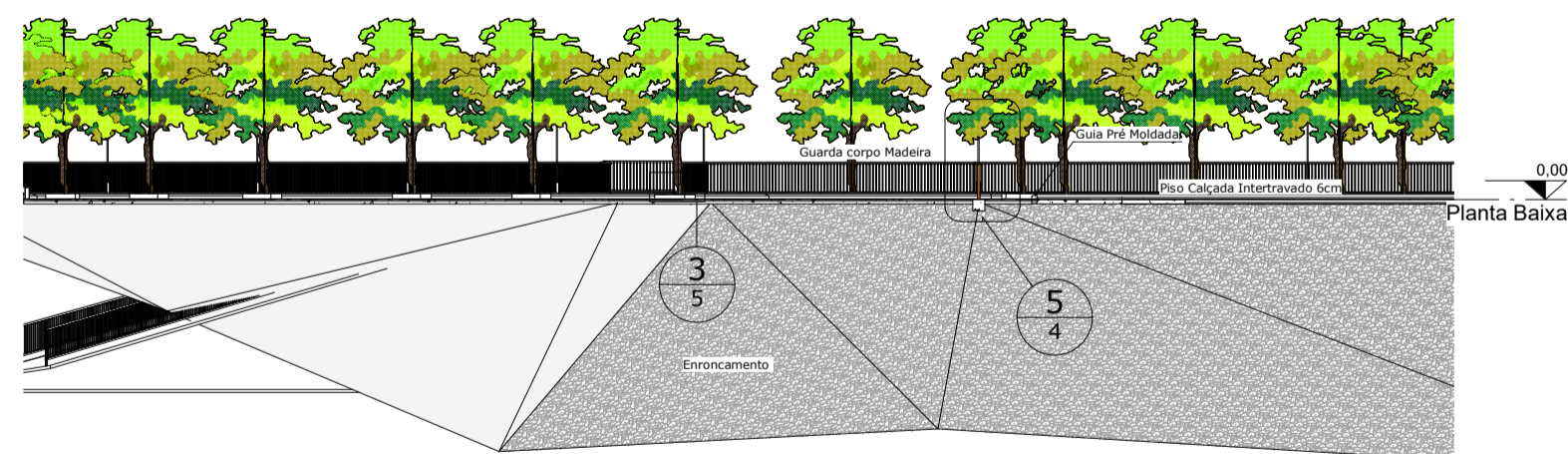

3 Corte AA
1 : 250

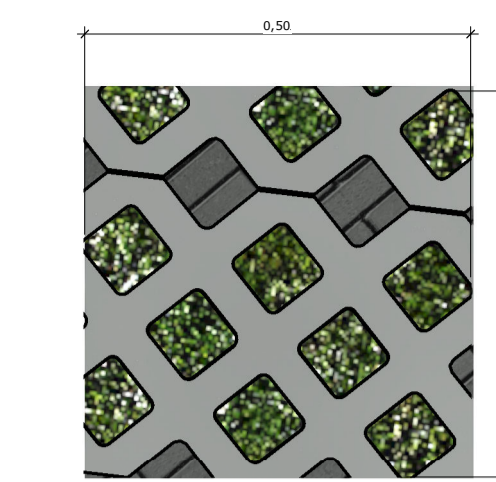
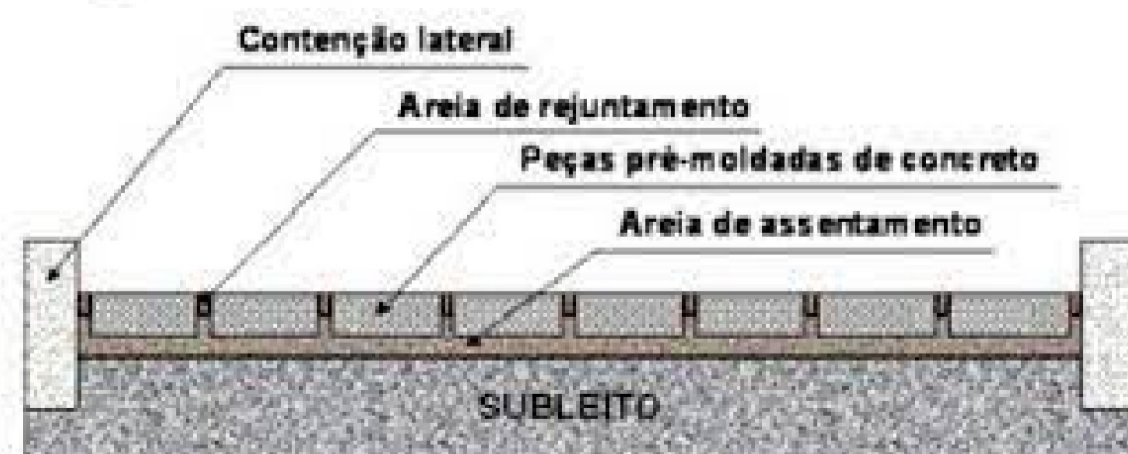

6 Bloco drenante
1 : 10

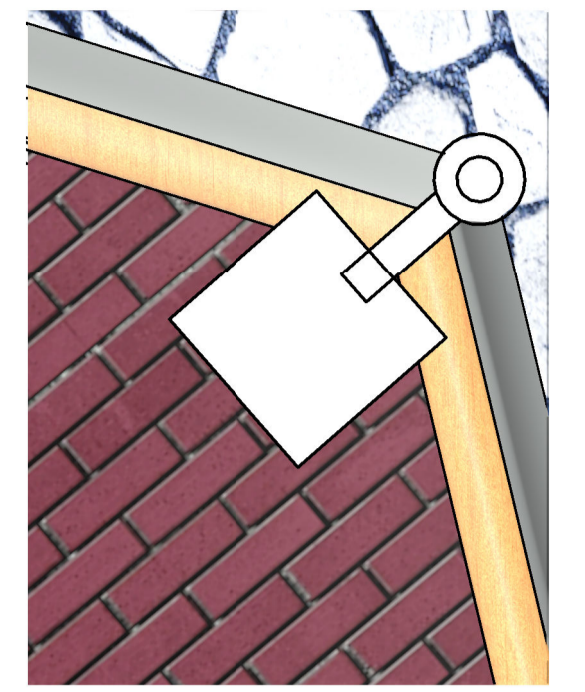

2 Det. Poste Tubular
1 : 10

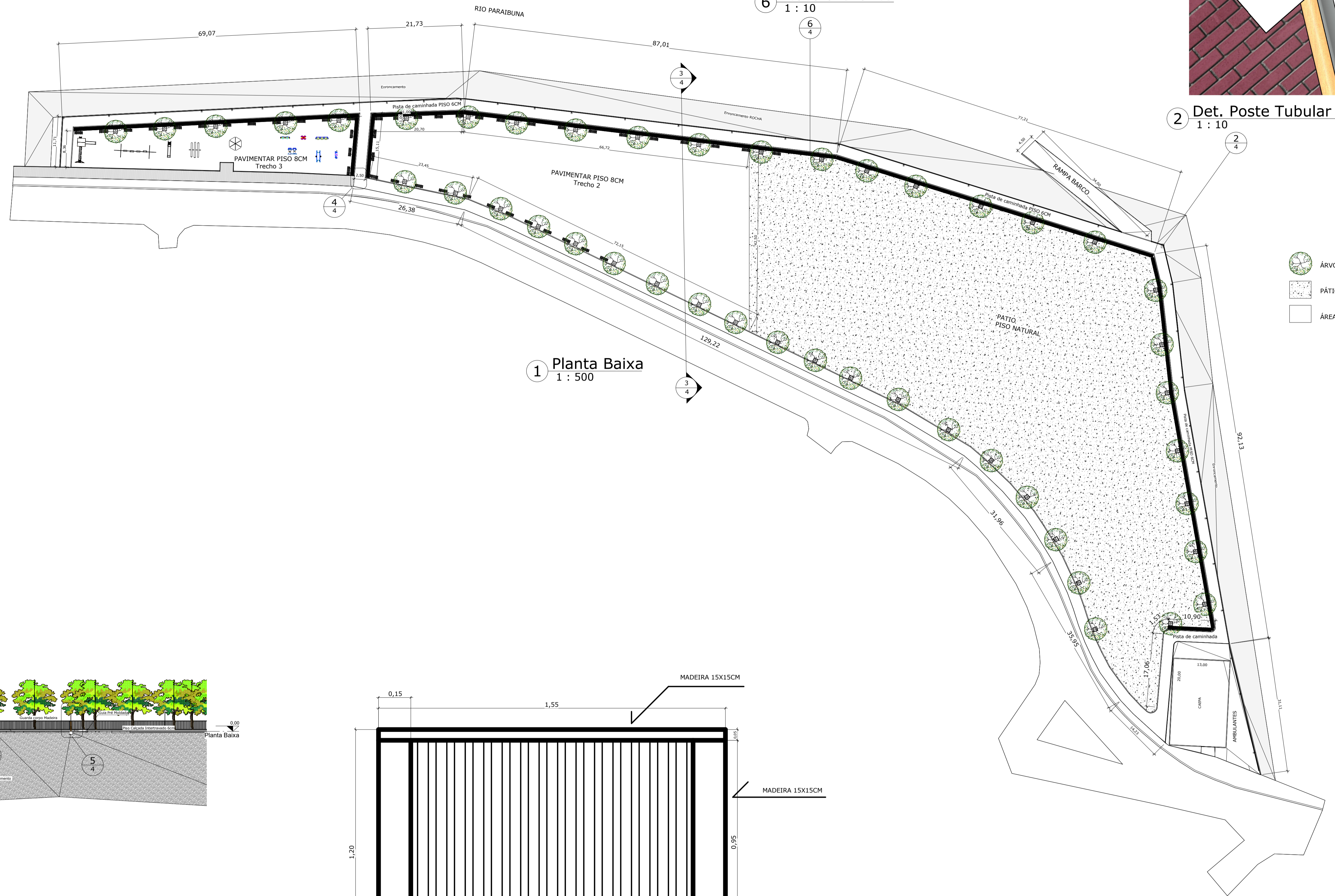

1 Planta Baixa
1 : 500

- ÁRVORE A IMPLANTAR
- PÁTIO PISO NATURAL
- ÁREA A PAVIMENTAR

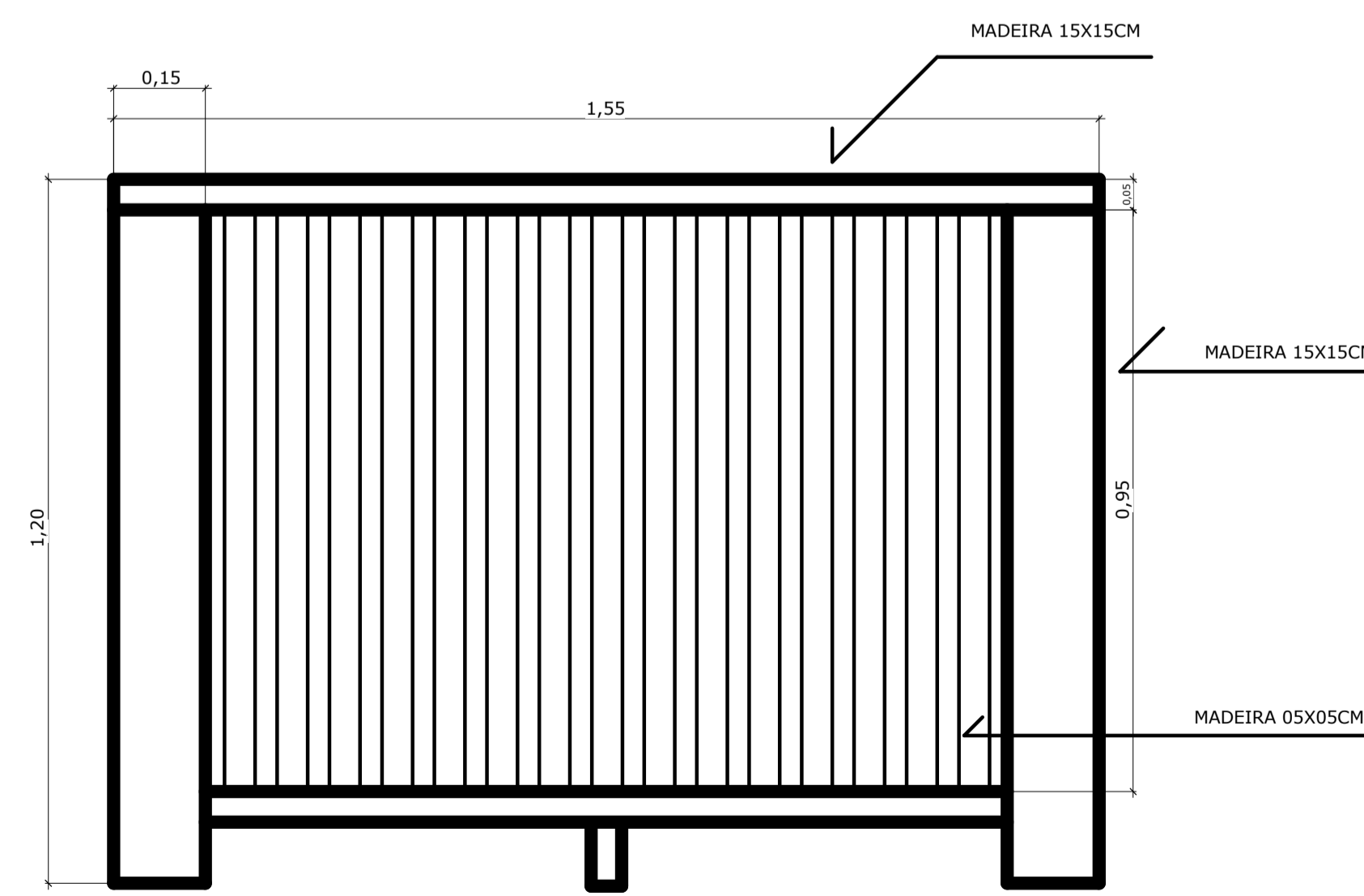

2 Det. Guarda Corpo Madeira
Sem escala

DADOS:

ÁREA A PAVIMENTAR PÁTIO: 3532,75M²
 ÁREA A PAVIMENTAR PISTA CAMINHADA: 1457,75M²
 ÁREA BLOCO DRENANTE: 531,00M²

Projeto Arquitetônico		Assunto:	Indicadas
Local: Av. Carlos Guimarães, Centro - Paraibuna/SP		Proprietário:	Desenho:
Prefeitura da Estância de Paraibuna		Data:	10/11/2023
Autor do Projeto Arq. Thais Cristine Amâncio Laurindo CAU: A1585754 RRT: 13733465 RRT: 12790240 RRT: 13733358		Prefeito Municipal Victor de Cássio Miranda	
		4/07	