

**PILARES**

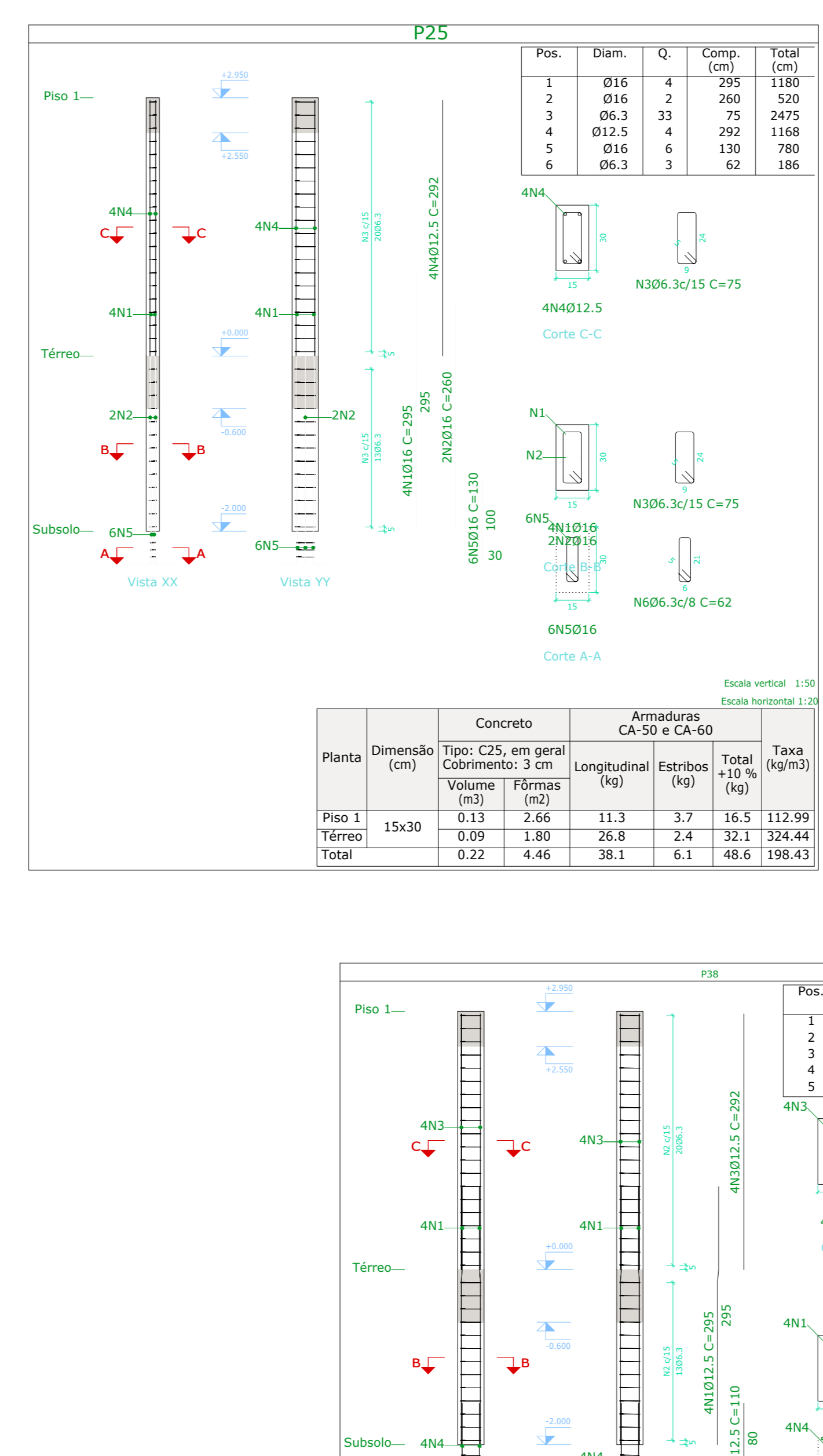
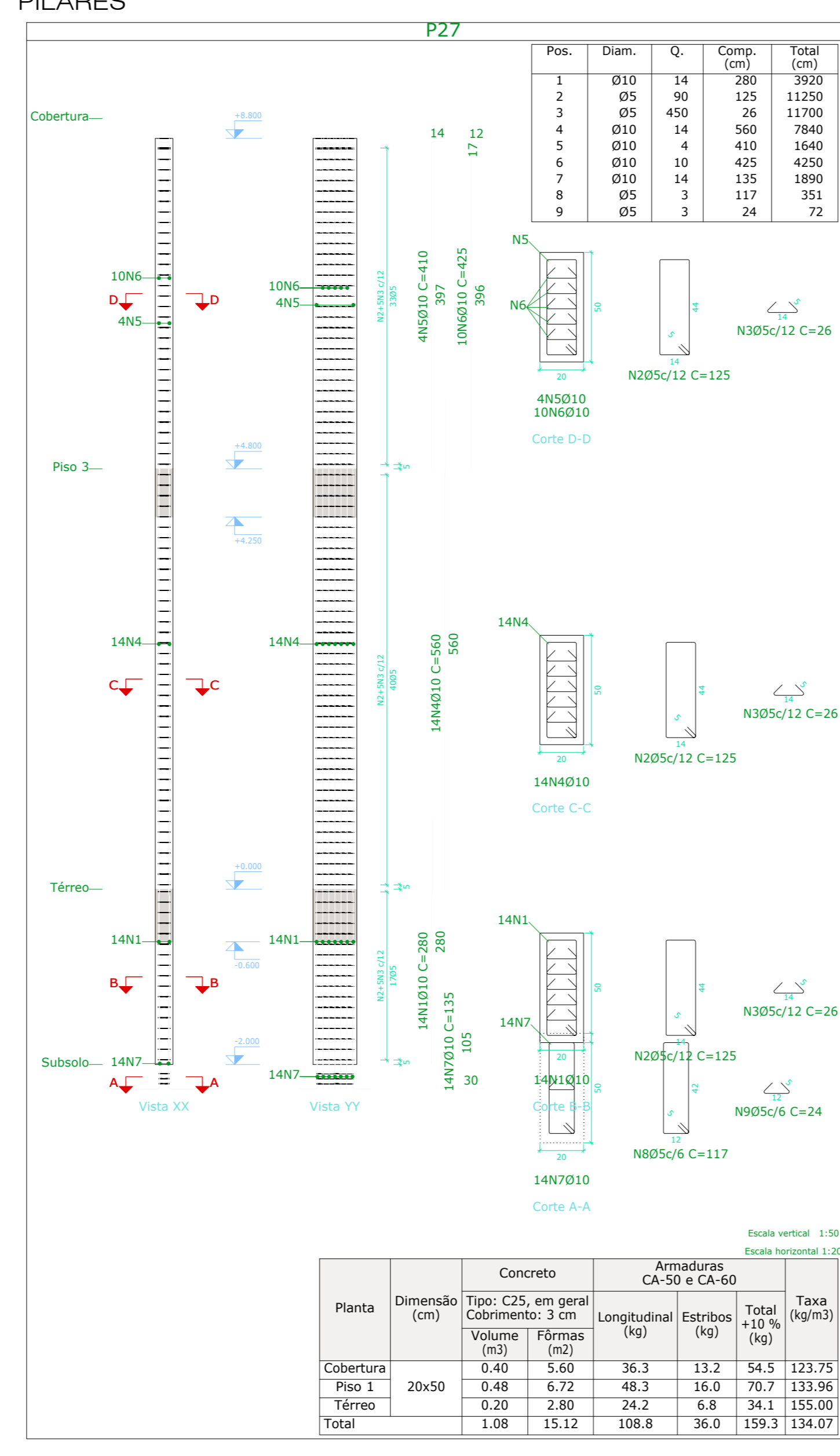

**Elemento**

| Elemento   | Pos. | Diam. | Q. | Esquema (cm) | Comp. (cm) | Total (cm) | CA-50 (kg) | CA-60 (kg) | Taxa (+10%) (kg) |     |  |
|------------|------|-------|----|--------------|------------|------------|------------|------------|------------------|-----|--|
| P78        | 1    | Ø10   | 4  |              | 280        | 1120       | 6.9        |            | 4.2              |     |  |
|            | 2    | Ø10   | 2  |              | 280        | 560        | 3.5        |            | 2.3              |     |  |
|            | 3    | Ø5    | 41 |              | 65         | 2665       |            | 120        | 520              | 3.2 |  |
|            | 4    | Ø10   | 4  |              | 292        | 1168       | 7.2        |            | 0.4              |     |  |
|            | 5    | Ø10   | 6  |              | 100        | 600        | 3.7        |            | 0.4              |     |  |
| Total+10%: |      |       |    |              |            |            |            |            | 8.9              | 3.0 |  |
| P40        | 1    | Ø10   | 4  |              | 280        | 1120       | 6.9        |            | 4.2              |     |  |
|            | 2    | Ø5    | 17 |              | 26         | 442        |            | 197        | 788              | 4.9 |  |
|            | 3    | Ø10   | 4  |              | 560        | 2240       | 13.5       | 540        | 3.3              |     |  |
|            | 4    | Ø5    | 3  |              | 79         | 237        |            | 79         | 237              | 0.4 |  |
| Total+10%: |      |       |    |              |            |            |            |            | 19.0             | 5.0 |  |
| P27        | 1    | Ø10   | 4  |              | 280        | 1120       | 6.9        |            | 4.2              |     |  |
|            | 2    | Ø5    | 41 |              | 65         | 2665       |            | 120        | 520              | 3.2 |  |
|            | 3    | Ø10   | 4  |              | 292        | 1168       | 7.2        |            | 0.4              |     |  |
|            | 4    | Ø5    | 3  |              | 79         | 237        |            | 79         | 237              | 0.4 |  |
| Total+10%: |      |       |    |              |            |            |            |            | 19.0             | 5.0 |  |

**Elemento**

| Elemento   | Pos.       | Diam. | Q.  | Esquema (cm) | Comp. (cm) | Total (cm) | CA-50 (kg) | CA-60 (kg) | Taxa (+10%) (kg) |      |     |  |
|------------|------------|-------|-----|--------------|------------|------------|------------|------------|------------------|------|-----|--|
| P25        | 1          | Ø16   | 4   |              | 295        | 1180       | 18.6       |            | 17.8             | 0.6  |     |  |
|            | 2          | Ø16   | 2   |              | 260        | 520        | 8.2        |            | 8.2              | 0.0  |     |  |
|            | 3          | Ø6.3  | 33  |              | 75         | 2475       | 6.1        |            | 11.3             | 5.2  |     |  |
|            | 4          | Ø12.5 | 4   |              | 292        | 1168       | 11.3       |            | 11.3             | 0.0  |     |  |
|            | 5          | Ø16   | 6   |              | 130        | 780        | 12.3       |            | 12.3             | 0.0  |     |  |
|            | 6          | Ø6.3  | 3   |              | 62         | 186        | 0.5        |            | 0.5              | 0.0  |     |  |
|            | Total+10%: |       |     |              |            |            |            |            |                  | 62.7 |     |  |
|            | P40+P46    | 1     | Ø10 | 8            |            | 280        | 2240       | 13.8       |                  | 18.4 | 4.6 |  |
|            |            | 2     | Ø5  | 94           |            | 26         | 2454       |            | 120              | 520  | 8.2 |  |
|            |            | 3     | Ø5  | 150          |            | 26         | 3900       |            | 26               | 3900 | 6.1 |  |
| 4          |            | Ø10   | 8   |              | 560        | 4480       | 18.5       |            | 18.5             | 0.0  |     |  |
| 5          |            | Ø10   | 4   |              | 110        | 440        | 5.1        |            | 5.1              | 0.0  |     |  |
| 6          |            | Ø10   | 4   |              | 205        | 820        | 5.1        |            | 5.1              | 0.0  |     |  |
| 7          |            | Ø10   | 4   |              | 470        | 1880       | 11.4       |            | 11.4             | 0.0  |     |  |
| 8          |            | Ø10   | 2   |              | 485        | 970        | 6.0        |            | 6.0              | 0.0  |     |  |
| 9          |            | Ø10   | 8   |              | 140        | 1120       | 6.9        |            | 6.9              | 0.0  |     |  |
| 10         |            | Ø5    | 3   |              | 117        | 351        | 0.6        |            | 0.6              | 0.0  |     |  |
| Total+10%: |            |       |     |              |            |            |            |            | 73.7             | 23.6 |     |  |

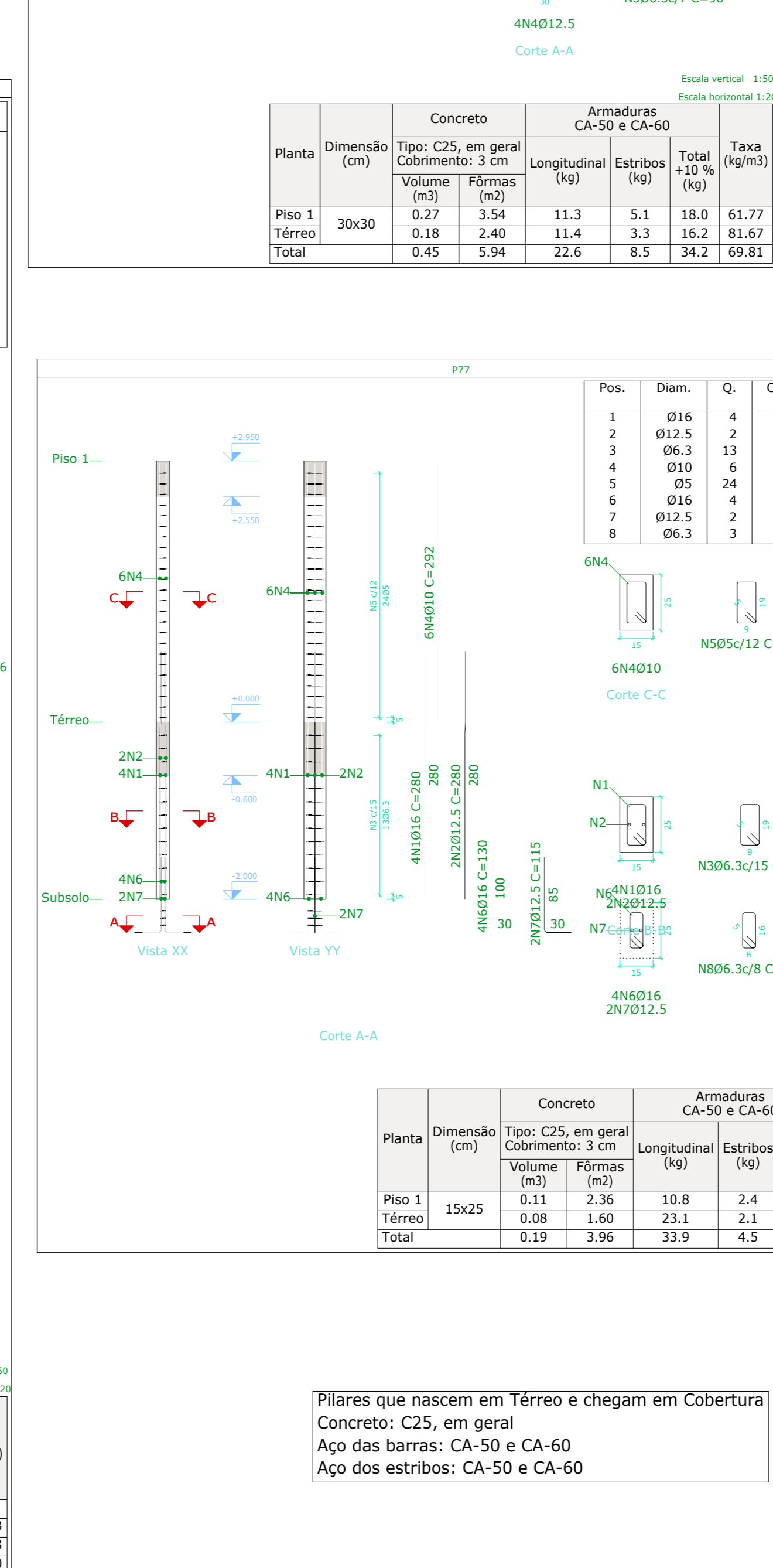
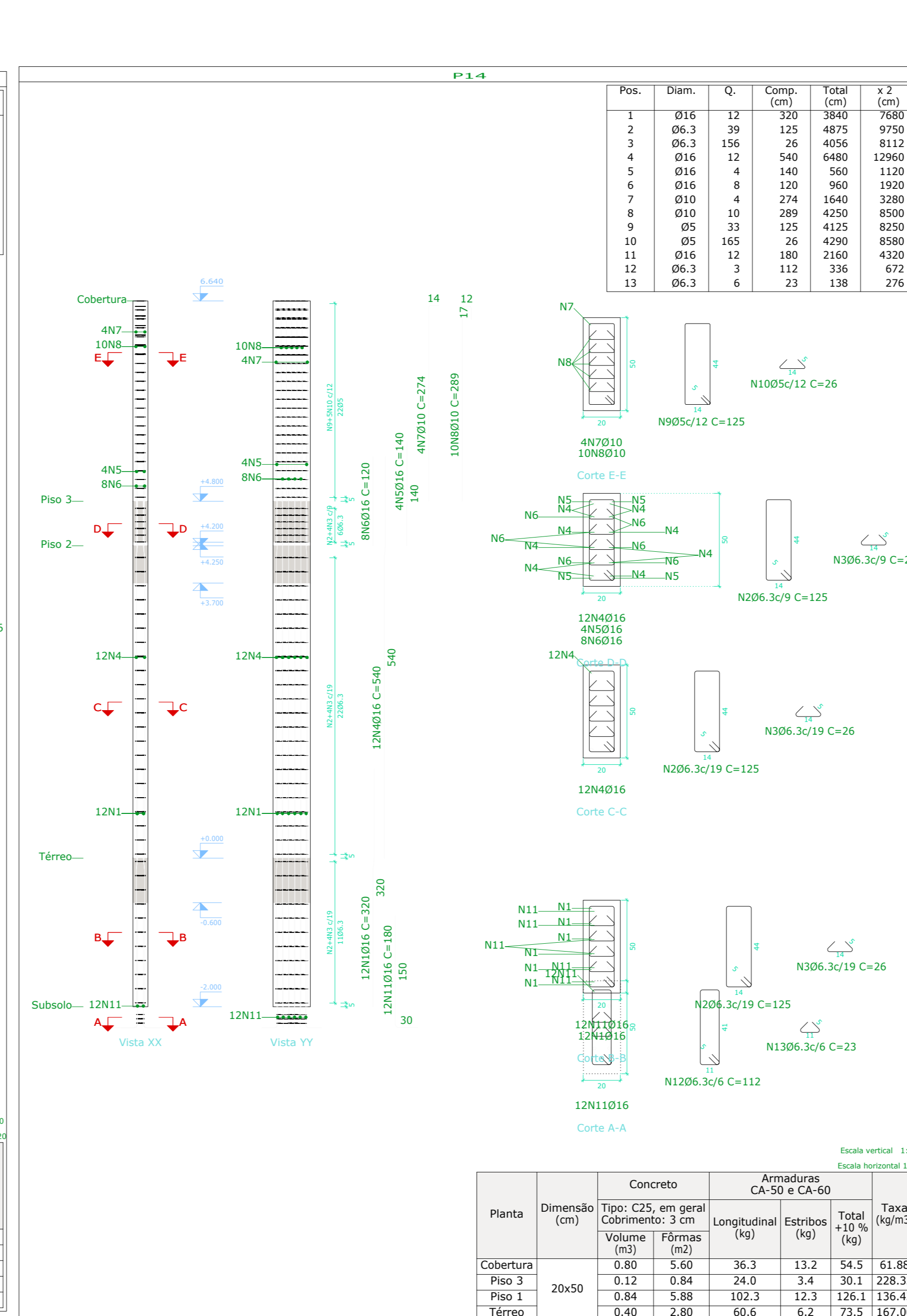
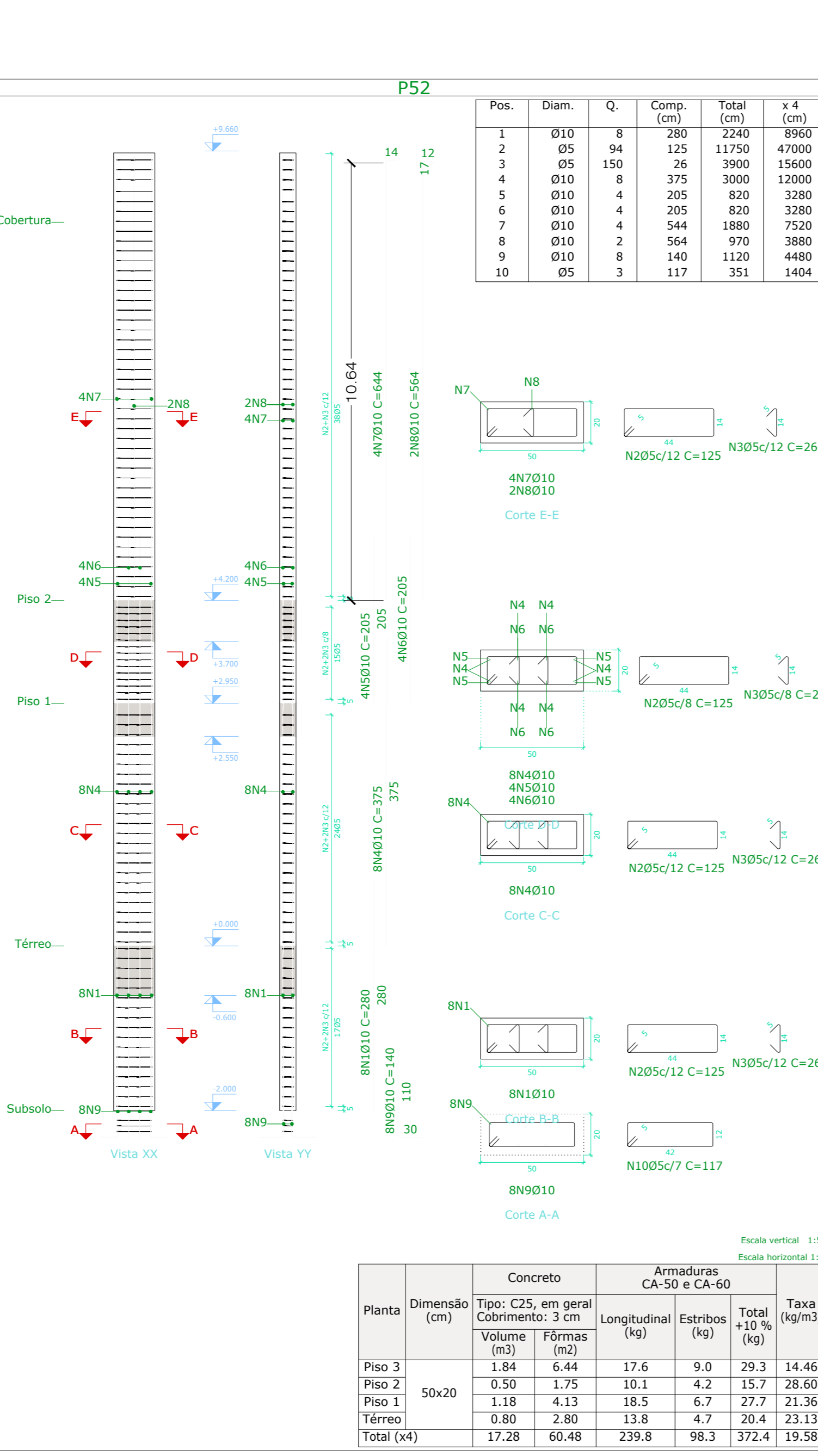
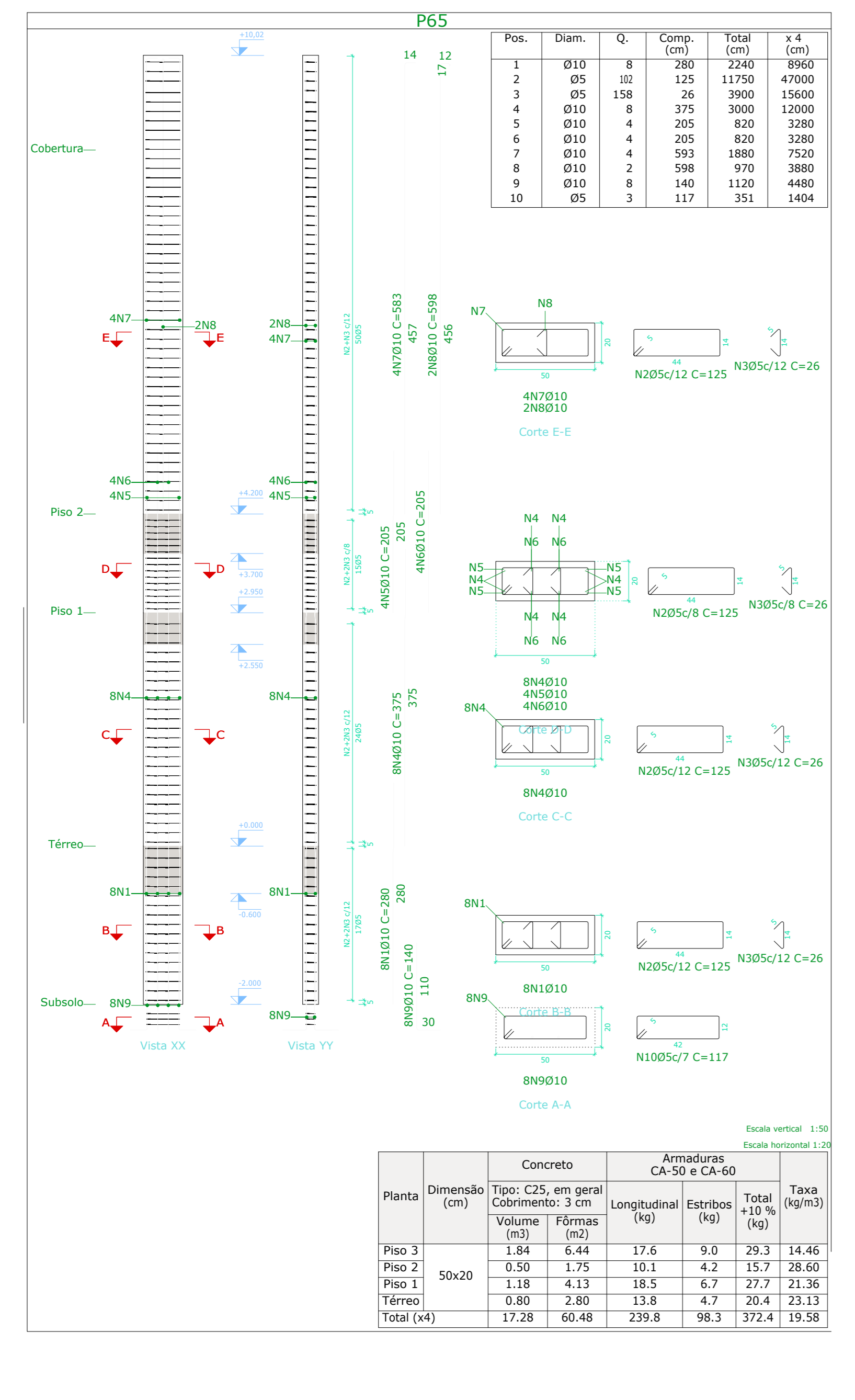

Pilares que nascem em Térreo e chegam em Cobertura  
 Concreto: C25, em geral  
 Aço das barras: CA-50 e CA-60  
 Aço dos estribos: CA-50 e CA-60

| N° | DATA | REVISÃO | RESPONSÁVEL |
|----|------|---------|-------------|
|    |      |         |             |
|    |      |         |             |

A

| N° | DATA | REVISÃO | RESPONSÁVEL |
|----|------|---------|-------------|
|    |      |         |             |
|    |      |         |             |

B

| N° | DATA | REVISÃO | RESPONSÁVEL |
|----|------|---------|-------------|
|    |      |         |             |
|    |      |         |             |

C

| N° | DATA | REVISÃO | RESPONSÁVEL |
|----|------|---------|-------------|
|    |      |         |             |
|    |      |         |             |

D

|  |          |   |  |          |   |
|--|----------|---|--|----------|---|
| PROJETO POR:<br>ROCHA & FRANÇA PROJETOS e Engenharia |          |   | PREFEITURA MUNICIPAL DE ILHA COMPRIDA<br>ESTÂNCIA BALNEÁRIA<br>AVENIDA BEIRA MAR 11000 - CEP 11925-000 |          |   |
| RES: CAROLINE VAZ RODRIGUES                          | SET/2017 | PROJETO CENTRO CULTURAL, ESPORTIVO E DE LAZER | RES: CAROLINE VAZ RODRIGUES  | SET/2017 | PROJETO CENTRO CULTURAL, ESPORTIVO E DE LAZER |
| ASS: CAROLINE VAZ RODRIGUES                          | SET/2017 | PROJETO CENTRO CULTURAL, ESPORTIVO E DE LAZER | ASS: CAROLINE VAZ RODRIGUES  | SET/2017 | PROJETO CENTRO CULTURAL, ESPORTIVO E DE LAZER |
| RES: CAROLINE VAZ RODRIGUES                          | SET/2017 | PROJETO CENTRO CULTURAL, ESPORTIVO E DE LAZER | RES: CAROLINE VAZ RODRIGUES  | SET/2017 | PROJETO CENTRO CULTURAL, ESPORTIVO E DE LAZER |
| ASS: CAROLINE VAZ RODRIGUES                          | SET/2017 | PROJETO CENTRO CULTURAL, ESPORTIVO E DE LAZER | ASS: CAROLINE VAZ RODRIGUES  | SET/2017 | PROJETO CENTRO CULTURAL, ESPORTIVO E DE LAZER |

F