

NOTAS

-A distância horizontal dos pontos poderá ser alterada para que se encaixe perfeitamente na passagem vertical por dentro dos blocos de alvenaria horizontal, evitando quebras.

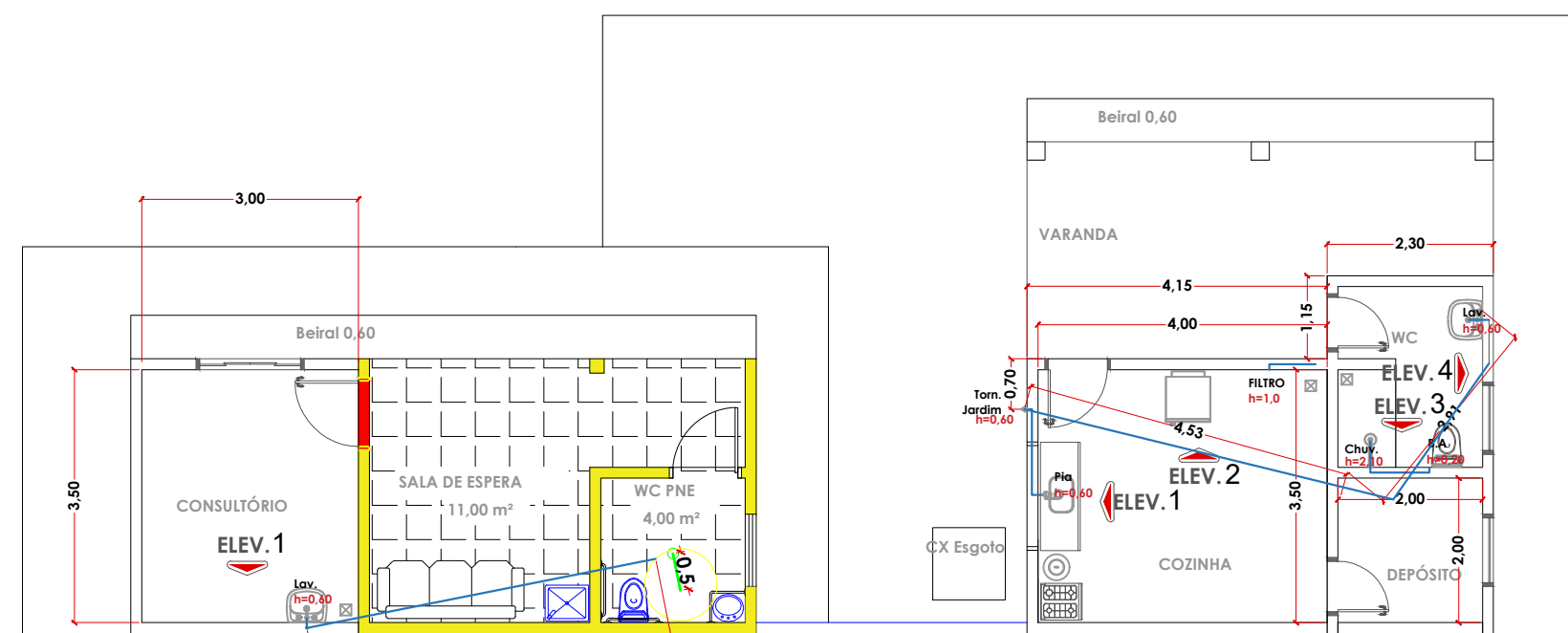

Planta Água Fria
Escala 1/100

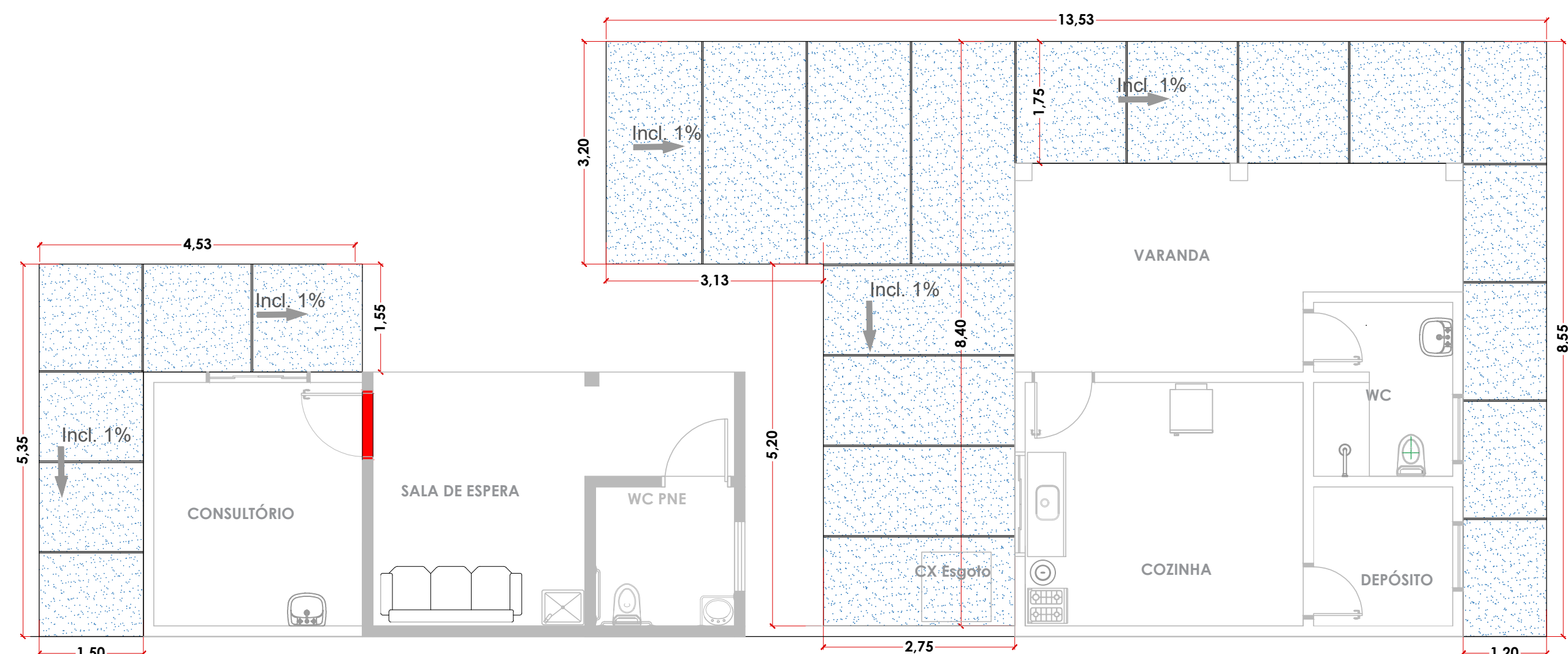

CONSULTÓRIO

COZINHA

ÁREA DE CONCRETO= 67,44m²

Planta Concreto e Calçamento
Escala 1/75

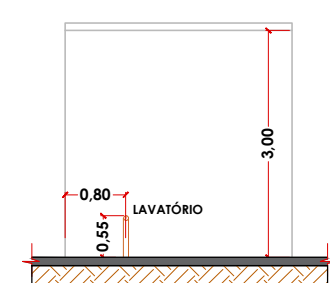

ESGOTO - CONSULTÓRIO

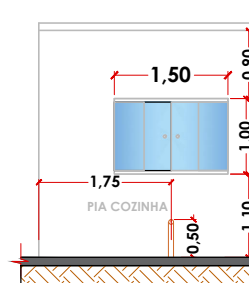
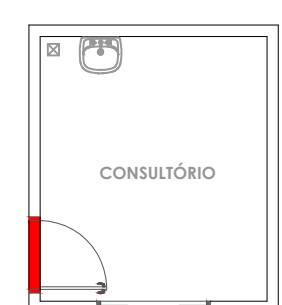

ESGOTO - COZINHA

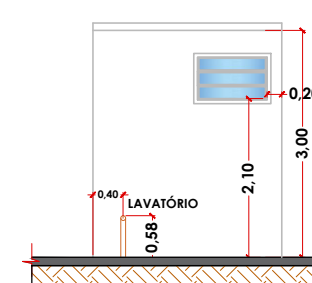
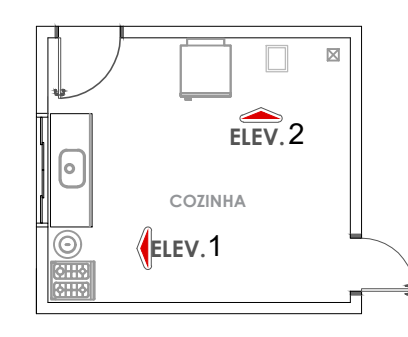
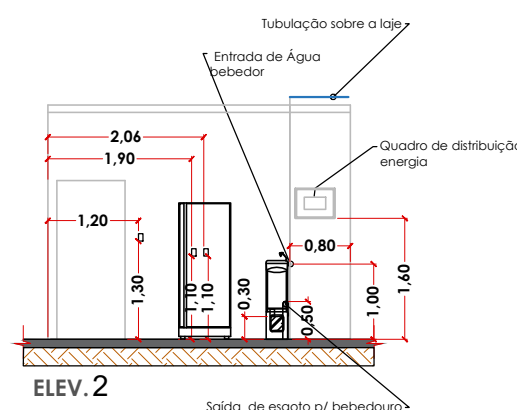

ESGOTO - BANHEIRO

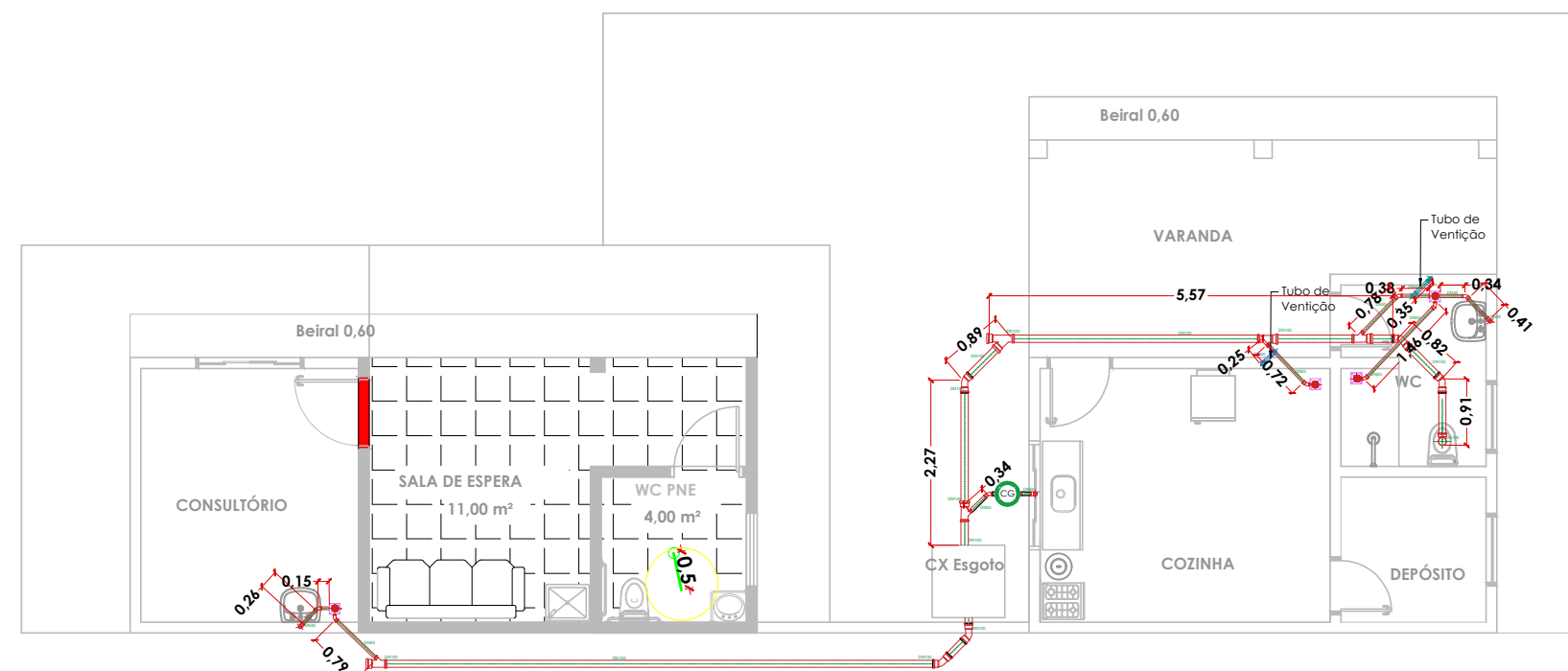
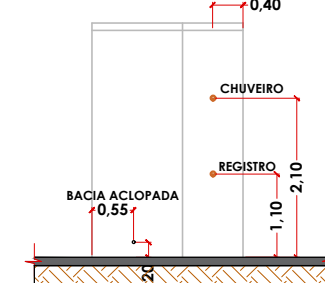
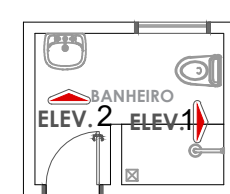

Planta Esgoto
Escala 1:100

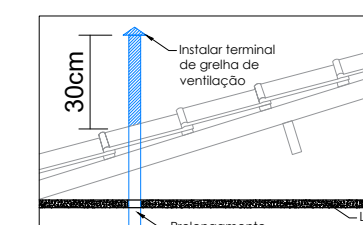

DETALHE COLUNA DE VENTILAÇÃO



PREFEITURA MUNICIPAL DE ESTIVA GERBI

FOLHA
2/4

OBRA:
**AMPLIAÇÃO E REFORMA DA EQUOTERAPIA
"ISABELA VITÓRIA DOS SANTOS ARAUJO"**
LOCAL:
**CENTRO ESPORTIVO MÁRIO ROCHA, LOCALIZADO A
RUA NELSON ROSA Nº 153**
BAIRRO:
VILA NOVA ESTIVA CEP: 13857-116
MUNICÍPIO:
ESTIVA GERBI ESTADO:
SÃO PAULO
PROPRIETÁRIO:
PREFEITURA MUNICIPAL DE ESTIVA GERBI

SITUAÇÃO SEM ESCALA:



PREFEITURA MUNICIPAL DE ESTIVA GERBI
PREFEITO MUNICIPAL
MARCIO ROBERTO PAVAN

QUADRO DE ÁREAS

CONSULTÓRIO11,97 m²
COZINHA, DEPÓSITO, WC E VARANDA43,93 m²
TOTAL.....55,90 m²

RESPONSÁVEL TÉCNICO
ENGENHEIRO CIVIL JAIME ABREU JUNIOR
CREA/SP: 5070155651-SP
ART:2620252007180